

M747/RL-DK01

CLAVIER DIGICODE FACTICE DE PORTE D'ENTREE

EN - USER INSTRUCTIONS

PLEASE READ THE MANUAL BEFORE YOUR FIRST USE. KEEP THIS MANUAL SAFE FOR FUTURE REFERENCE!

INTRODUCTION

Ce clavier digicode de porte d'entrée factice sera un élément dissuasif pour les intrus, suggérant une protection électronique par alarme de votre domicile. La LED rouge clignotante en permanence simulera son fonctionnement

PRODUCT DESCRIPTION

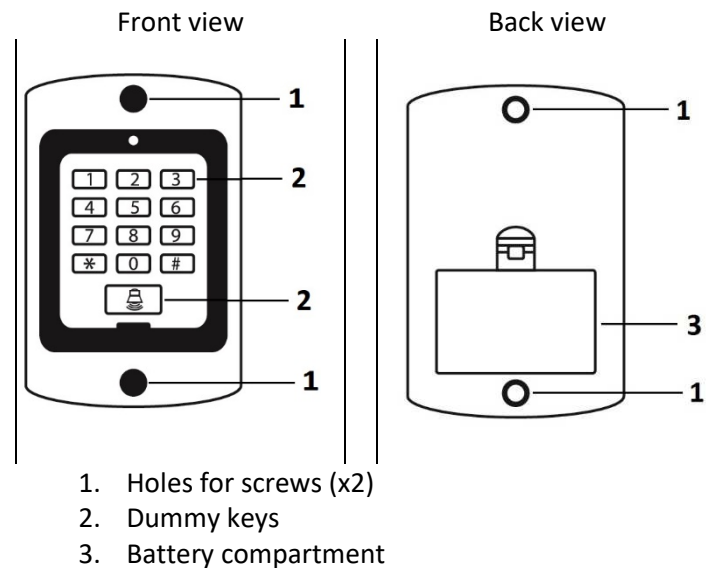

Hardware provided:

- 2 screws
- 2 wall plugs

BATTERY INSTALLATION

Power supply: 3 AA/LR06 batteries (not provided).

1. Remove the battery compartment cover by pressing the tab.
2. Install the batteries taking care to observe the correct polarities (+ and -) shown inside the compartment.
3. Replace the cover.

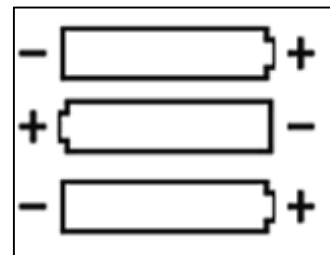

INSTALLATION



1. Choose the outside or inside location where you wish to fit the dummy keypad.

If the keypad is fitted outdoors, position it so that it is protected from extreme weather, heat or damp. Do not expose to rain.

2. Mark the positions of the 2 holes to be drilled in the wall.
3. Drill the holes using an appropriate drill bit for the substrate.
4. If necessary, push the wall plugs provided or other suitable wall plugs into the holes in the substrate.
5. Position the keypad on the wall and insert the 2 screws provided.
6. Tighten the screws.

OPERATION

In the dark or at night, the light sensor built in to the keypad will switch on the backlighting to make the keys clearly visible.

This product is not a toy. Keep out of the reach of children.

SAFE INSTRUCTIONS FOR BATTERY:

- Never mix alkaline, standard (carbon-zinc) and rechargeable (nickel hydride).
- Don't mix new and used batteries.
- Don't attempt to recharge non rechargeable batteries.
- Remove rechargeable batteries from the device (if possible) before charging them.
- Rechargeable batteries must always be recharged under adult supervision.
- Remove used batteries.
- Never short the power supply terminals.
- Always use the recommended or equivalent battery types.
- Always pay attention to battery polarity.

WARNING: You should not dispose of this device with your household waste. A selective collection system for this type of product is implemented by your local authorities. Please contact your local authorities to find out how and where collection takes place. These restrictions apply because electrical and electronic devices contain dangerous substances that have harmful effects on the environment or on human health and must be recycled.

This symbol indicates that electrical and electronic devices are collected selectively. The symbol shows a waste container crossed out with an X symbol.

Imported by PRODIS SAS, 1 rue de Rome, 93110 Rosny-sous-Bois, France
Marketed by EUROTUPS VERSAND GMBH D-40764 LANGENFELD, Germany
Made in PRC

